



Los Angeles, CA  
Tel: 424.247.6550

## Italforni BULL Installation

### RECEIVING

Read the notice on the outside carton regarding damage in transit. **"Concealed Damage"**, damage discovered after opening the crate(s), must be reported immediately to the carrier. The carrier will perform an inspection of the damage and furnish forms for the consignee's claim against the carrier. Retain all packing material-including outer carton until the inspection has been completed.

### LOCATION & MINIMUM CLEARANCES

Adequate air space must be provided for proper venting of the controls and provisions must be made for venting of the cooking vapors. The Oven must be installed in a well-ventilated area and following minimum clearances must be maintained at all times:

- A 3" minimum air space **MUST** be left on the **RIGHT SIDE** to allow adequate ventilation for the cooling of the controls. Access must also be available for service on the left side. Failure to do so will void the warranty.
- Ovens can be installed with **6"** clearances (back and sides only) from combustible and non-combustible materials.
- The ovens may be installed on combustible Flooring if mounted on the Legs provided.
- Keep the area around your oven free and clear of all combustible materials.

### INSTALLATION

Place the oven and parts as close to the area of final installation before uncrating. Your ovens are packed sitting on their bottom. The ovens may be flipped on their side to get it through a smaller doorway- **STONES MUST BE SECURED BEFORE OVEN IS FLIPPED**. The pallet may be left under the oven for convenience in further handling. Unpack carefully to avoid damage to the oven. If concealed damage is discovered, follow the instructions detailed in section 1 above.

1. Set the base in the approximate spot that the ovens will be installed. The front of the base is marked as the front. Level the oven base with the floor.
2. Using proper lifting equipment, lift the bottom oven or single oven, on top of the base.
3. Align the front corners of the oven with the front corners of the base. Locate the four holes in the base with the same holes in the bottom of the oven and secure

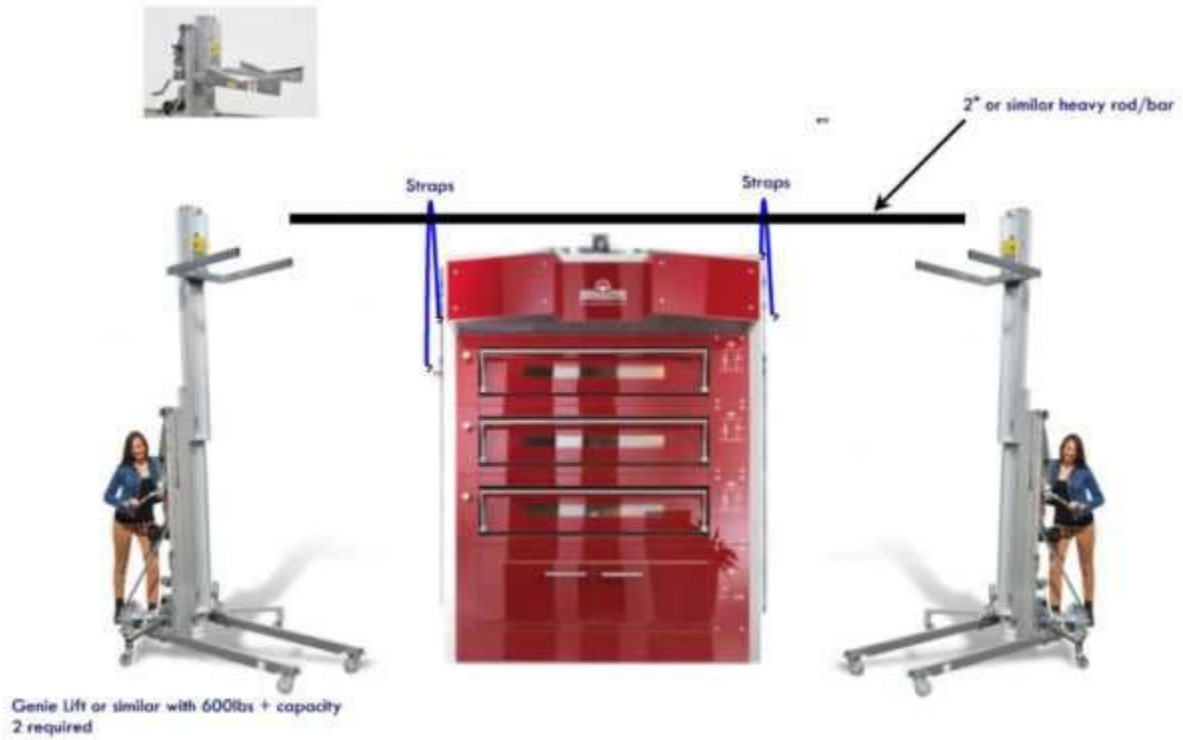

**Remove Glass before moving**

### **STACKING**

These ovens can be stacked up to three high. Each unit is built exactly the same, so it does not matter in what order they are stacked.

**NOTE: REMOVE ALL GLASS. Failure to do so will result in damage and is not covered**

Once the unit with the legs or the proofer is in place with the proper lifting equipment gently place the next oven on top of the first one and line up the back and sides with each other. In case of a third unit, gently place the oven on top of the second one and line up the back and sides.

## ELECTRICAL CONNECTION

### GENERAL INSTRUCTIONS

1. Only a licensed electrician should make the electrical connections.
2. Make sure electrical supply corresponds with that specified on the rating plate.
3. Only use copper conductors rated at 90°Celsius suitably sized for the electric current drawn.
4. All pole disconnect(s) must be provided by the installer.
5. When installed, unit must be electrically grounded in accordance with the local codes and/or the latest edition of the National Electric Code ANSI/NFPA No. 70 in USA or Canadian Electrical Code, CSA Standard C22.1, Part 1 in Canada.

## FIELD CONNECTIONS

1. Feed power cable (supplied by the customer) through the access hole at the [right](#) side or at the back of the oven and pull the cable to the Connection Terminal.
2. Following the appropriate wiring diagram conforming to the rating plate, connect the power supply leads to the field wiring terminal block. The ground wire should be connected to the grounding lug.
3. For a three phase 3-wire supplies, the controlling branch circuit is designed to operate at 208-240 volts AC.
4. Make sure all connections are tight, then replace the access cover(s) and control panel(s).

## VENTING

Where applicable the oven can be vented using either:

- A.) Direct Vent Method
- B.) Canopy Method

In the **Direct Vent Method**, the flue connector uniting the oven vents in the back can be connected to a separate line than the flue from the hood, then the two lines can exit the building. The two outlets [hood and the oven flue] can also be united and be diverted out using a single pipe as shown in the following diagram. In this method an inline fan must be placed on the ovens back flue BEFORE THE T CONNECTOR to prevent backdraft inside the decks.

No more than two 90° elbows should ever be used in a direct vent connection and all horizontal runs must have at least a 1" per foot pitch.

In the **Canopy Method**, the oven flue and the hood flue are left exposed and open facing the hood filters.

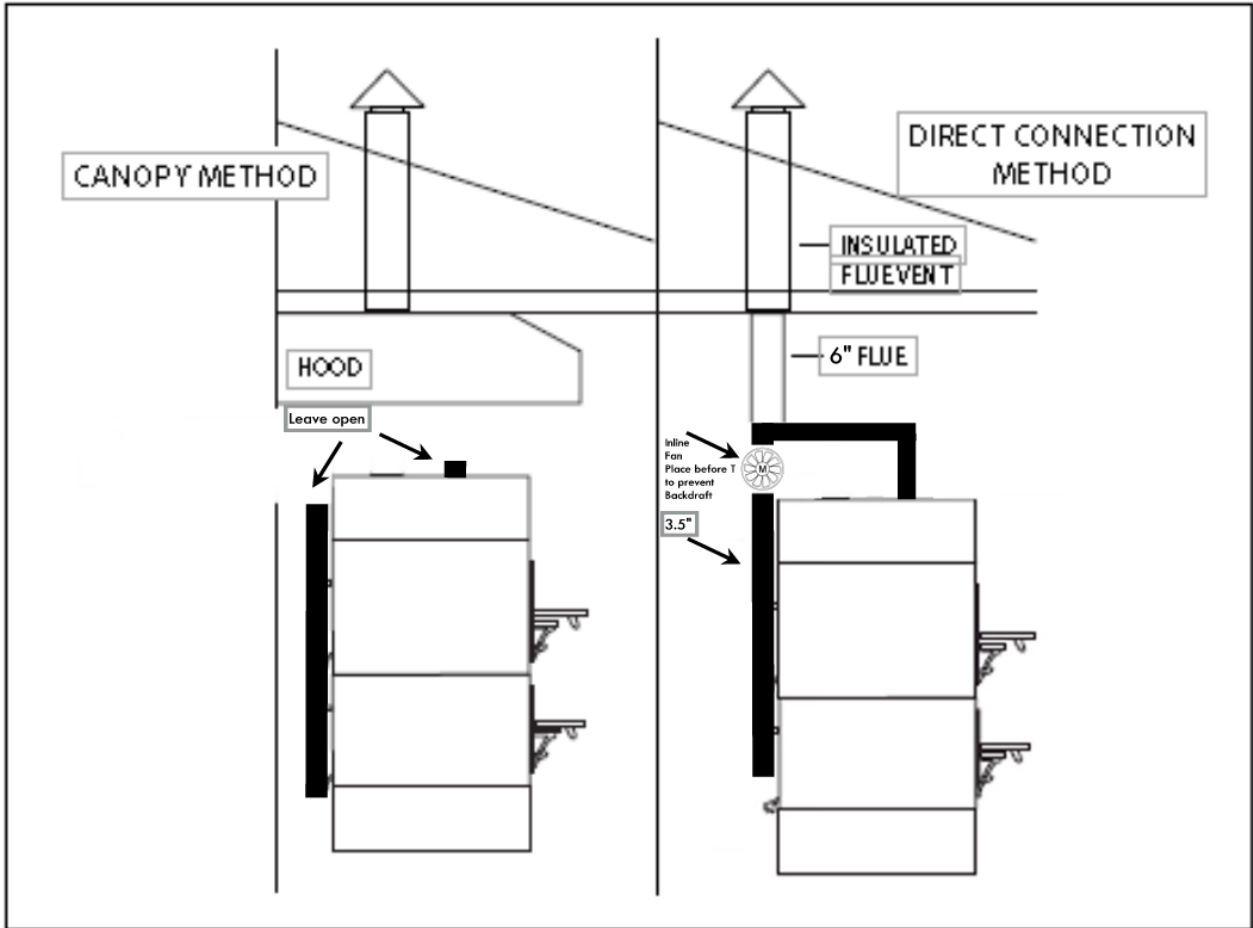

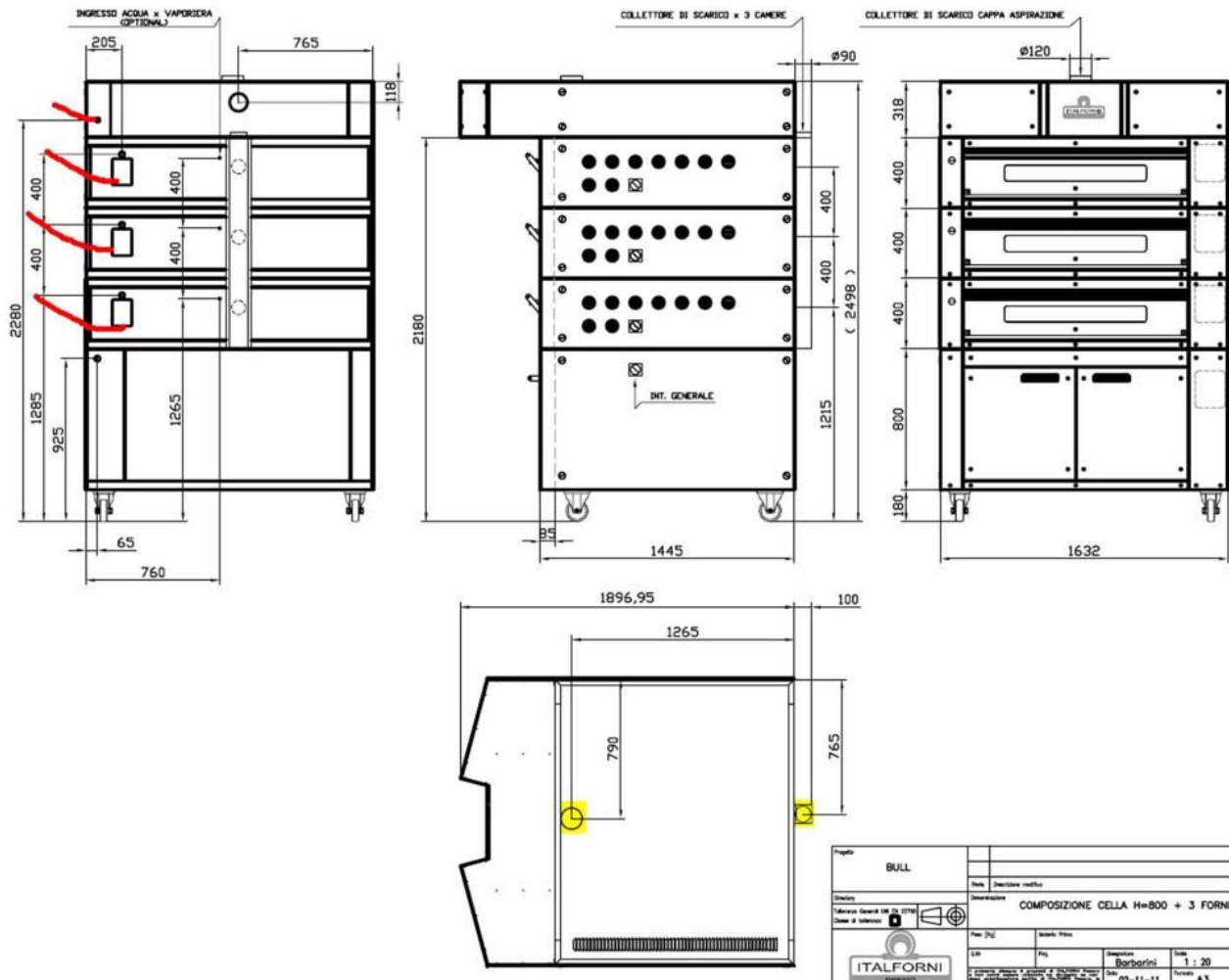

Project		BULL	
Client		Società	
Description		COMPOSIZIONE CELLA H=800 + 3 FORNI	
Scale	1:20	Date	02-11-11
Author	Barbarini	Project	A3

**In all instances LOCAL CODE PREVAILS.**

Please contact your local inspection authority for further permit requirements.